



HARMONDSWORTH PRIMARY SCHOOL

LONDON BOROUGH OF HILLINGDON

Asthma Policy

Harmondsworth Primary School positively welcomes all children with asthma and encourages them to partake in all activities to achieve their potential in all aspects of school life. As a school we recognise that asthma is a widespread, serious but controllable condition affecting many pupils. We encourage pupils with asthma to achieve their full potential in all aspects of school life by having a clear asthma policy that is understood by all staff.

At school

- All teaching and support staff are asthma aware and receive regular training from the relevant professionals.
- All children with asthma have rapid access to their emergency relief inhalers.
- There is good communication between home and school.
- When a child is admitted to school or is diagnosed with asthma the parents/carers are asked if their child has asthma on the enrolment forms.
- Parents/carers of children with asthma are asked to complete and return a 'school asthma card'. The information is used to compile a school asthma register.
- Parents/carers are asked to sign 'Permission to administer medication'. (form 3a)
- Parents/carers must inform the school and update the school asthma card if there is any change in their child's medication.
- We will do everything we can to ensure that our school provides the right environment and care for pupils with asthma and where possible reduce the presence of triggers.
- If administered, medication, dosage, date and time will be recorded.

Inhalers

- There is always rapid access to reliever inhalers; they will never be locked away.
- Parents/carers must supply the school with **two** relief inhalers, with the prescription label indicating dosage and the child's name. Only prescribed medication will be administered.
- One inhaler is held in the 'Medical box' located in the child's classroom.
- A second inhaler is held in the Welfare Room.
- A periodic check will be carried out to ensure every asthmatic child has the correct medication in school but responsibility lays with parents/carers to ensure all medication is within the use by date.
- Preventative Inhalers (Brown/Orange/Purple/Green) are not accepted in school.
- Children will never be given another child's inhaler, even if it is the same medication and dosage.
- Emergency medication will accompany the class at all times e.g. Trips, outdoor activities and any evacuation.



HARMONDSWORTH PRIMARY SCHOOL

LONDON BOROUGH OF HILLINGDON

-
- It is not a legal requirement for any member of staff to administer medication - however many are happy to do so if necessary. Whenever possible children will be encouraged to self administer under supervision.
 - Children will never be denied access to their inhaler.
 - Parents/carers will be informed if their child is using their medication more than usual.

Exercise & Activity

- We encourage all pupils to take part in sport and other activities.
- Staff are aware of children with asthma in their group.
- If required pupils can take their inhaler and rejoin the lesson when they have recovered.
- Pupils who suffer with exercise induced asthma will be reminded to take their medication before exercise.

Asthma Attacks

- Staffs receive training and know what to do in the event of an asthma attack.
- Procedures outlined by Asthma UK are displayed around school and in every classroom.

Role of the Governing Body

- To ensure there is clear policy and guidance applied by the Head Teacher

The asthma policy will be accessible to parents and will feature on the school's website and on Fronter.

This policy will be reviewed annually.

Mrs Eleesa Dowding, Headteacher
Spring 2015

Ms Amanda Hill, Chair of Governors
Spring 2015



HARMONDSWORTH PRIMARY SCHOOL

LONDON BOROUGH OF HILLINGDON

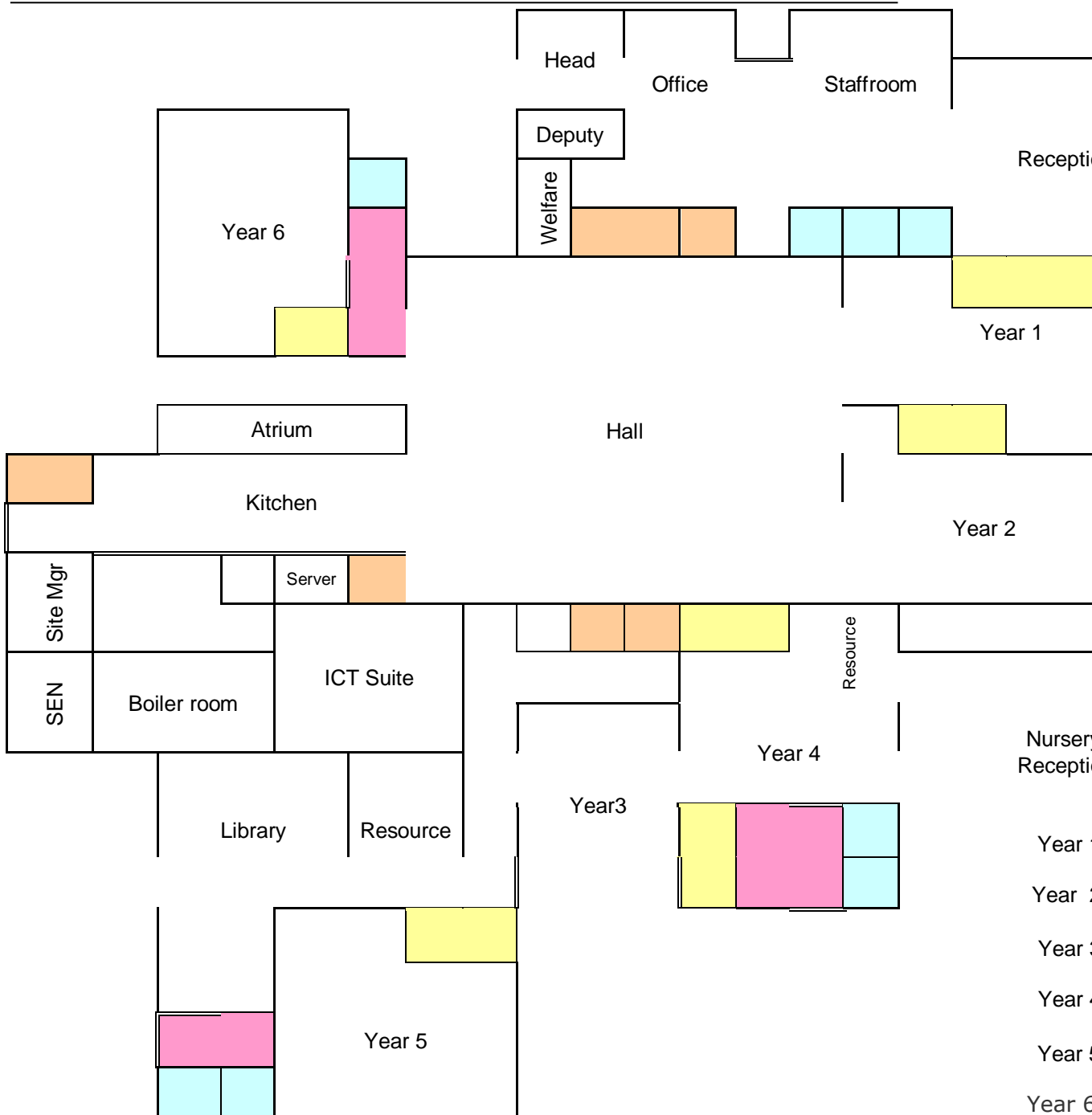

- Cupboards
- Toilets
- Storage
- Cloakroom

** kaisha Meds are kept in cl

Additional info
white cupboards
(Excl Yr 4,